

DIE WAGNEREI

ANNO  1919

LANGEN - BROMBACH

ALLEINIGER FABRIKANT VON ODENWÄLDER MARKTWAGEN

Premium Line

STREETFOOD • GRILL • DRINKS



Optimized space requirement with continuous work surface over the entire length of the wagon

Food, Grill, Sous vide

Beverage service, wine, beer, mulled wine

Ice cream from the freezer or ice cream freezer with display

Waffle or Crêpe

Price from 69.000€

(operated by two service staff)

DESCRIPTION

Metal tube frame primed and -black- painted/powdered • Carriage cladding from KömaCel® sheets • Solid wooden parts made of ash, glazed & varnished • Original wooden spoke wheels made of ash solid wood; iron fitting with rubber coating of the tread • Roof covering, awning cloth covering • 3 folding canopies with cloth covering and gas springs • 2 side windows • indoor curtain • Glass top at the dispenser • door and canopies lockable • 230V LED lightening • All-round shelf on outer cladding

EQUIPMENT OPTIONS

- Electric griddle roaster
- Electric-Bainmarie, GN 1/1
- Multi tray for bread rolls
- Hob
- Cooling table base with 4 cooling compartments and one door
- Boiler
- Hand wash basin
- Hygiene unit (soap, towel dispenser)
- Tap dispenser
- Dish washer
- Standing table, pluggable in the back
- 2 straight wall shelves
- 1 angled wall shelf (e.g. for baskets)
- Indoor curtain
- worksurface adjustable

TECHNICAL DATA

Measures

Total length:	5.200 mm
Body length:	3.850 mm
Body width:	1.700 mm
Total width (canopies open):	3.000 mm
Height:	2.480 mm
Total weight	1.950 kg
Water	Tank system / fixed water connection
Electricity	400 V / 16 A

DIE WAGNEREI

Owner Denny Pistner · Jürgen Weller · Oberdörfer Straße 14a · D-64753 Brombachtal
phone: +49 (0) 6063 8267500
info@wagnerei.de · www.wagnerei.de

DIE WAGNEREI

ANNO 1919

LANGEN - BROMBACH

ALLEINIGER FABRIKANT VON ODENWÄLDER MARKTWAGEN

Example of an interior design:

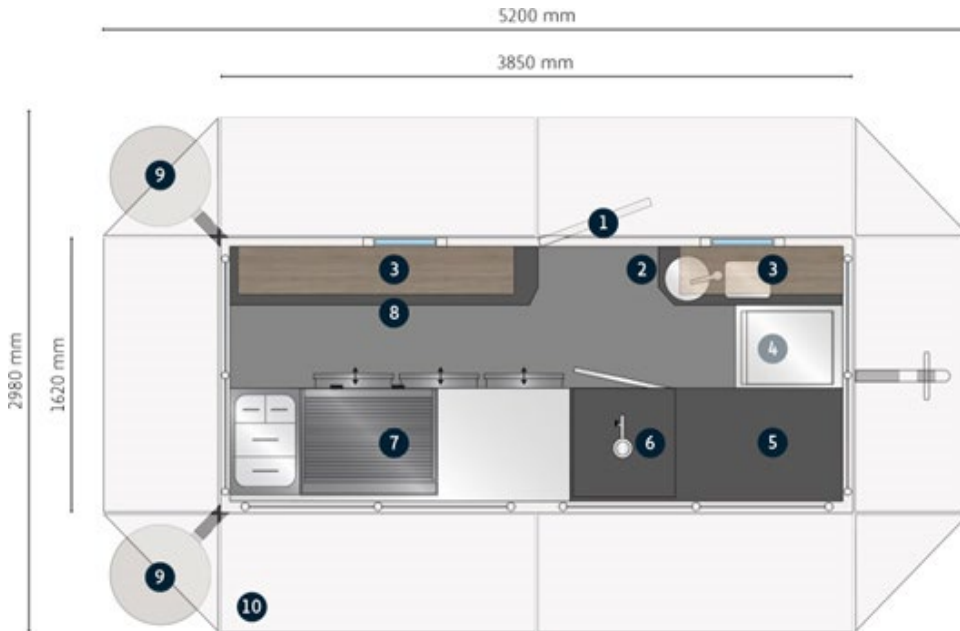

1. Entrance door
2. Double sink with Boiler
3. Shelves
4. Dish washer
5. work surface with cable aperture
6. tap station with barrel cooling
7. Bainmarie, multi tray for bread rolls and griddle roaster, underneath refrigerated table base with 6 cooling compartments
8. Work surface
9. Tables, pluggable
10. canopies

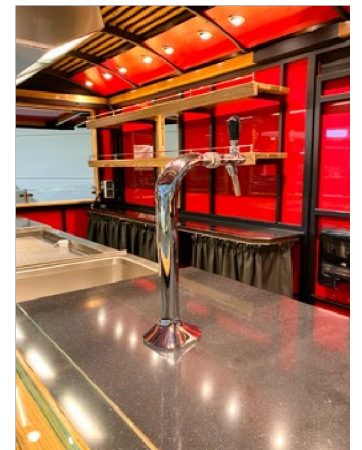

DIE WAGNEREI

Owner Denny Pistner · Jürgen Weller · Oberdörfer Straße 14a · D-64753 Brombachtal
 phone: +49 (0) 6063 8267500
 info@wagnerei.de · www.wagnerei.de